

**Hose Carrier HCP**

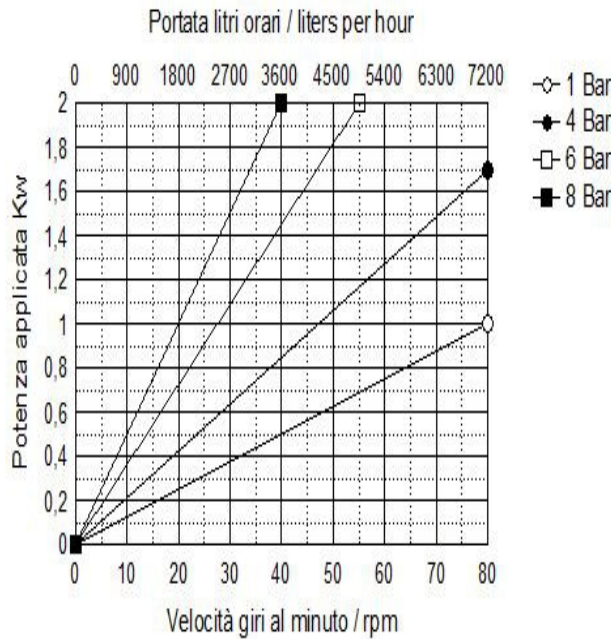

| DATI TECNICI   |             |
|--|-------------|
| Delivery max   | 7000 l/Hour |
| Head max*  | 8 bar       |
| Vacuum   | 0,95 bar    |
| Delivery per revolution                                | 1,5 liters  |
| Barb Hose  | DN 50       |
| Free passage   | 40 mm       |
| Weight   |             |
| Power Kw Kw  | 0,5 – 2     |
| Hose fiber reinforced available in different materials | NR          |
|  | NBR         |
|  | HYP         |
|  | EPDM        |
|  | NRA         |
| Leakage sensor   | Option      |
| Cooling device   | Option      |
| Different connections                                  | Option      |

| VERSIONS AVAILABLE                                 |
|--|
| Variables with mechanical speed variator, from 1:5 |
| Variable electronic inverter integrated IP 65      |
| Trailers for slow hand towing in site              |
| Electrical control panels aboard the machine       |

Note: in the presence of fluids particularly viscous, suspensions coarse solid, high delivery pressure, high temperatures, consider operate not more than 30 % of the maximum flow rate of the pump. \*According to the transmission applied

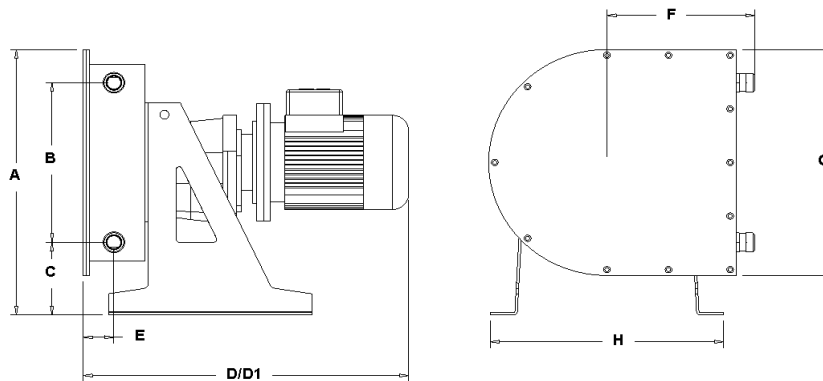

| DIMENSIONS |     |     |     |         |    |     |     |     |   |        |        |
|------------|-----|-----|-----|---------|----|-----|-----|-----|---|--------|--------|
| A          | B   | C   | D   | D1(VAR) | E  | F   | G   | H   | I | Out/In | Weight |
| 660        | 440 | 145 | 652 | 840     | 76 | 361 | 592 | 506 | - | DN 50  |        |

The dimensions are not binding and can vary without notice