

TECHNICAL DATA	
Delivery max	3500 l/Hour
Head max*	7 bar
Vacuum	0,95 bar
Delivery per revolution	0,723 liters
Barb hose	DN 40
Free passage	30 mm
Weight	
Power Kw	0,5-1,5
Hose fiber reinforced available in different materials	NR
	NBR
	HYP
	EPDM
	NRA
Leakage sensor	Option
Cooling device	Option
Different connections	Option

**VERSIONS AVAILABLE**

- Variables with mechanical speed variator, from 1:5
- Variable electronic inverter integrated IP 65
- Trailers for slow hand towing in site
- Electrical control panels aboard the machine

Note: in the presence of fluids particularly viscous, suspensions coarse solid, high delivery pressure, high temperatures, consider operate not more than 30 % of the maximum flow rate of the pump.  
 \*According to the transmission applied

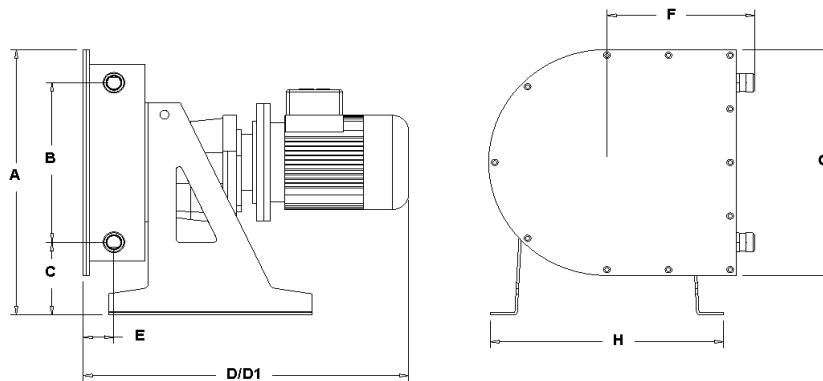

DIMENSIONS											
A	B	C	D	D1(VAR)	E	F	G	H	I	Out/In	Weight
550	348	136	590	800	65	290	480	446	-	DN 40	

The dimensions are not binding and can vary without notice